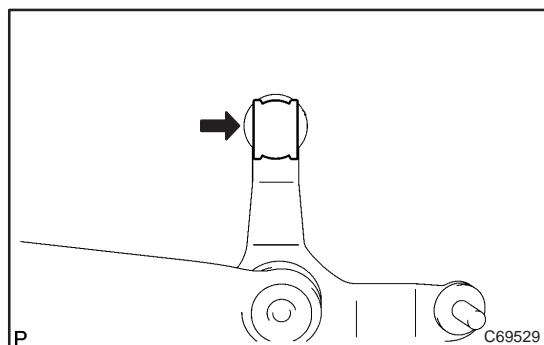

SHIFT & SELECT LEVER SHAFT ASSY (E355/E356)

OVERHAUL

41041-01

HINT:

COMPONENTS: [See page 41-1](#)

1. REMOVE CONTROL SHIFT LEVER BUSH

- (a) Remove the control shift lever bush from the selecting bellcrank No.2.

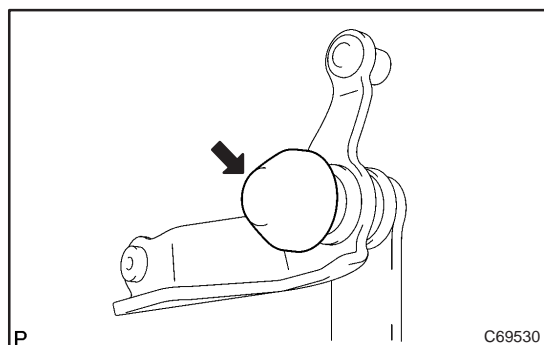

2. REMOVE SELECTING BELLCRANK DUST COVER NO.1

- (a) Remove the selecting bellcrank dust cover No.1 from the selecting bellcrank No.2.

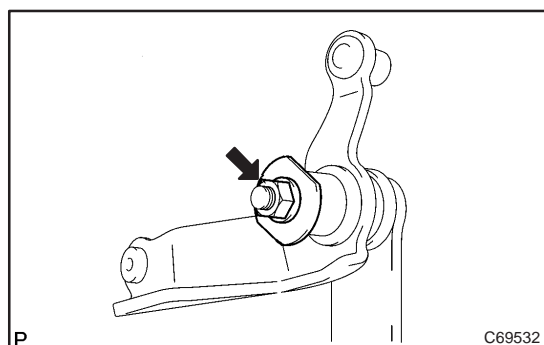

3. REMOVE SELECTING BELLCRANK SUPPORT SUB-ASSY

- (a) Remove the nut, washer and selecting bell crank No.2 plate washer from the selecting bellcrank No.2.

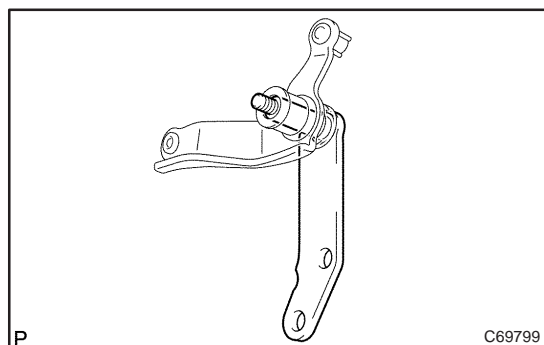

- (b) Remove the selecting bellcrank support sub-assy from the selecting bell crank No.2.

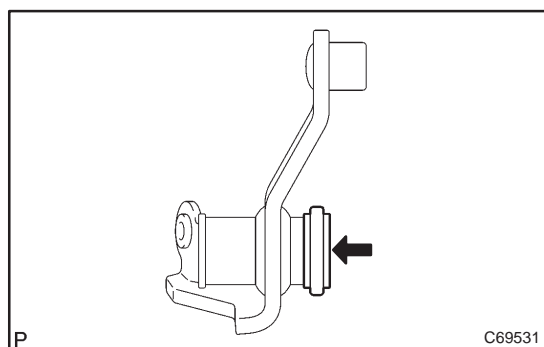

4. REMOVE SELECTING BELLCRANK DUST COVER NO.2

- (a) Remove the selecting bell crank dust cover No.2 from the selecting bellcrank no.2.

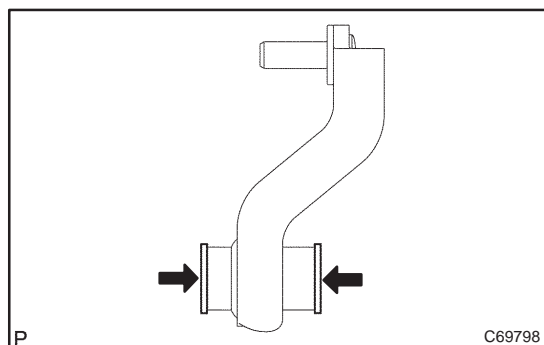

5. REMOVE SELECTING BELLCRANK NO.2 BUSH

- (a) Remove the selecting bellcrank bush from the selecting bellcrank No.2.

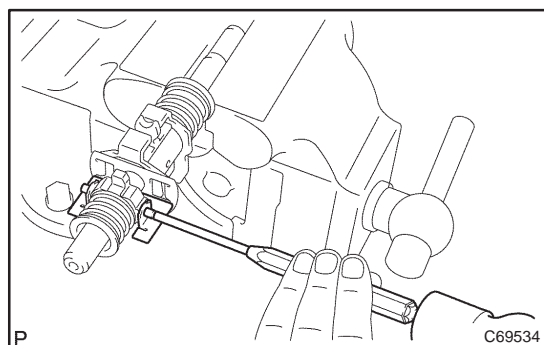

6. REMOVE SHIFT LEVER INNER NO.2

- (a) Fix the shift & select lever on the the vise through the soft jaw.

NOTICE:

Do not damage the shift & select lever shaft.

- (b) Using a pin punch(ϕ 5 mm), remove the shift & select lever inner slotted pin and oil baffle.

NOTICE:

Do not damage the shift & select lever shaft.

- (c) Apply the force to the select return spring No.1 and select return spring No.2 and fix it on the vise through the soft jaw.

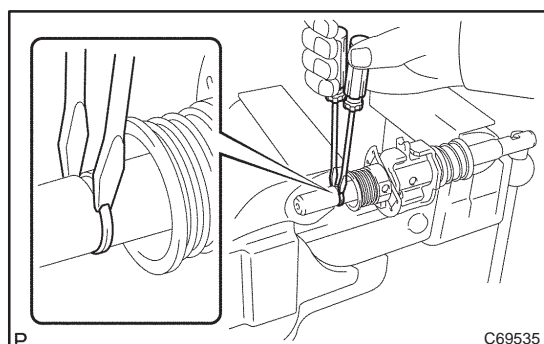

- (d) Using 2 screwdrivers and a hammer, remove the select seat snap ring from the shift & select lever shaft.

NOTICE:

Do not damage the shift & select lever shaft.

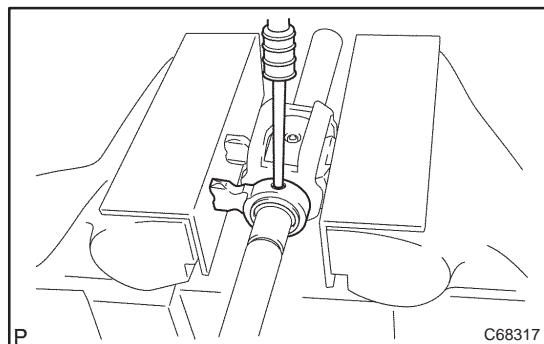

7. REMOVE SELECT SPRING SEAT NO.1

- (a) Using a pin punch(ϕ 5 mm), remove the shift inner lever slotted pin from the shift & select lever shaft.

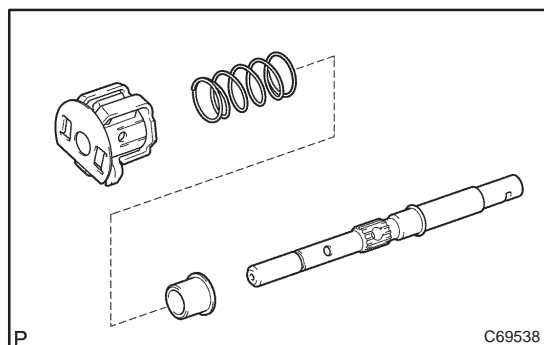

- (b) Remove the shift lever assy select return spring No.1 and select spring seat from the shift & select lever shaft.

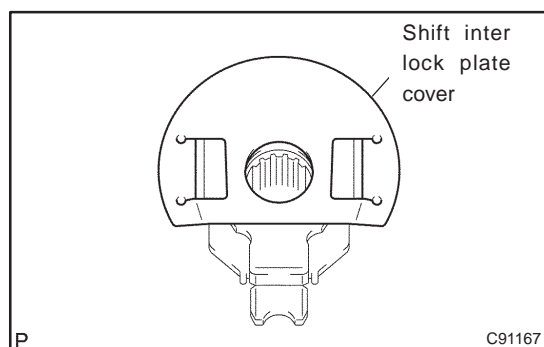

8. REMOVE SHIFT INTER LOCK PLATE COVER

- (a) Remove the shift inter lock plate cover from the shift inter lock plate.

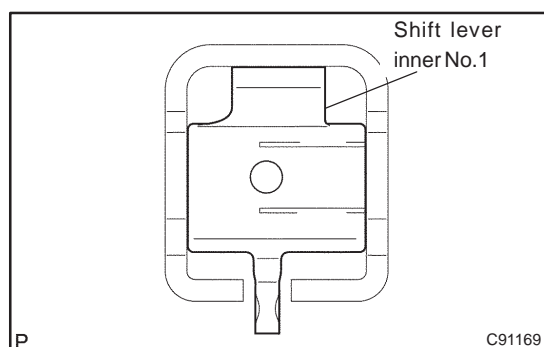

9. REMOVE SHIFT LEVER INNER NO.1

- (a) Remove the shift lever inner No.1 from the shift inter lock plate.

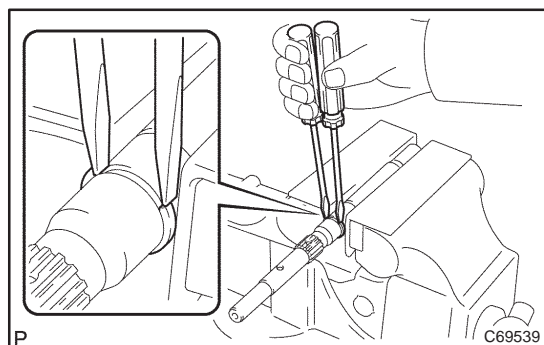

10. REMOVE SELECT SPRING NO.1 SEAT SHAFT SNAP RING

- (a) Using 2 screwdrivers and a hammer, remove the select spring No.1 seat shaft snap ring.

NOTICE:

Do not damage the shaft.

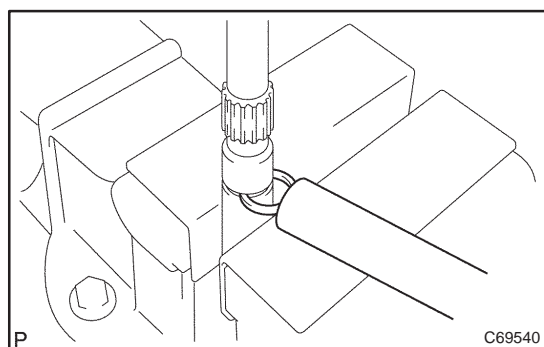

11. INSTALL SELECT SPRING NO.1 SEAT SHAFT SNAP RING

- (a) Using a brass bar and a hammer, install the select spring No.1 seat shaft snap ring.

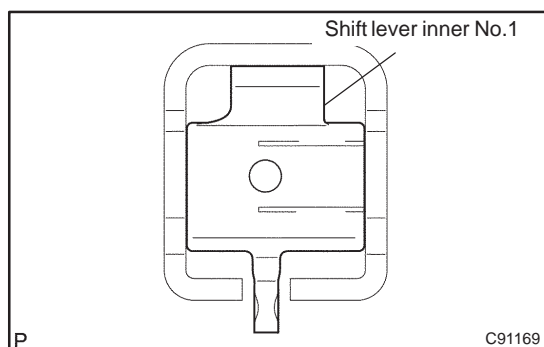

12. INSTALL SHIFT LEVER INNER NO.1

- (a) Install the shift lever inner No.1 to the shift inter lock plate.

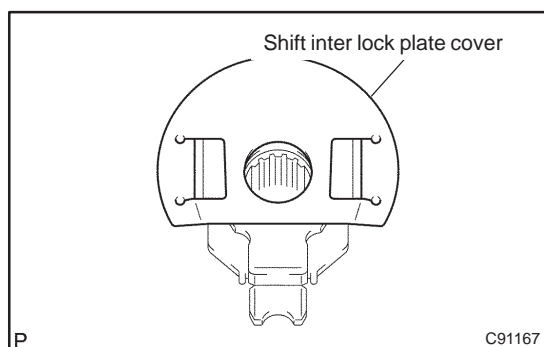

13. INSTALL SHIFT INTER LOCK PLATE COVER

- (a) Install the shift inter lock plate cover to the shift inter lock plate.

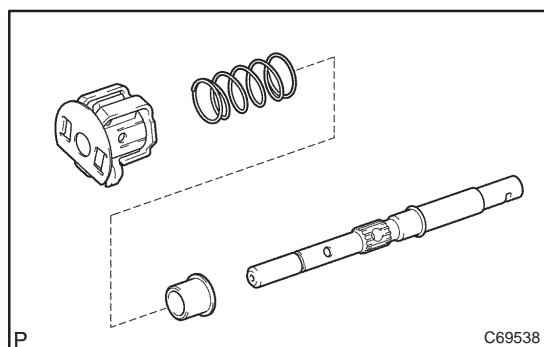

14. INSTALL SELECT SPRING SEAT NO.1

- (a) Install the select spring seat No.1, select return spring No.1 and shift lever inner assy to the shift & select lever shaft.

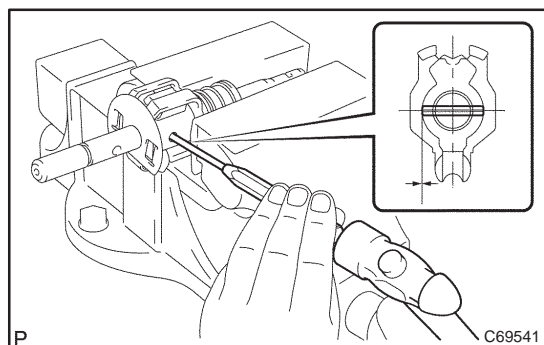

- (b) Fix the shift & select lever on the vise through the soft jaw.
 (c) Using a pin punch (φ 5 mm), install the shift lever slotted pin to the shift & select lever shaft.

Clearance: -0.5 – 0.5 mm (– 0.0199 – 0.0199 in.)

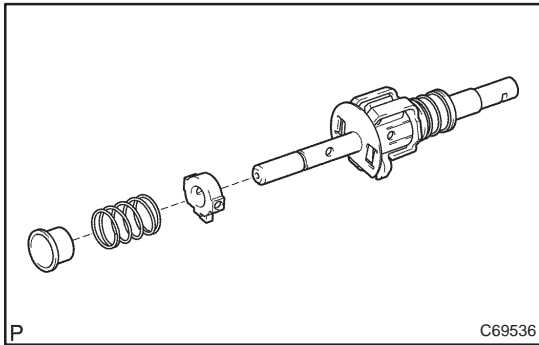

15. INSTALL SHIFT LEVER INNER NO.2

- (a) shift lever inner No.2, select return spring No.2 and select return spring seat No.2 to the shift & select lever shaft.

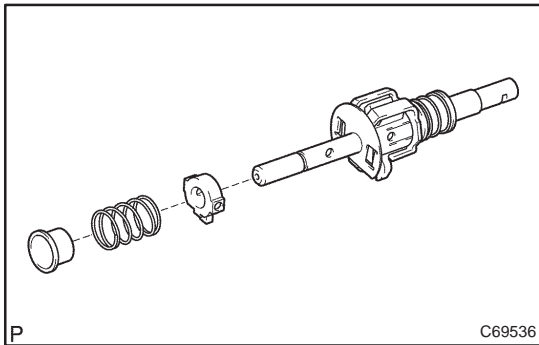

- (b) Using a brass bar and a hammer, install the select seat snap ring to the shift & select lever shaft.

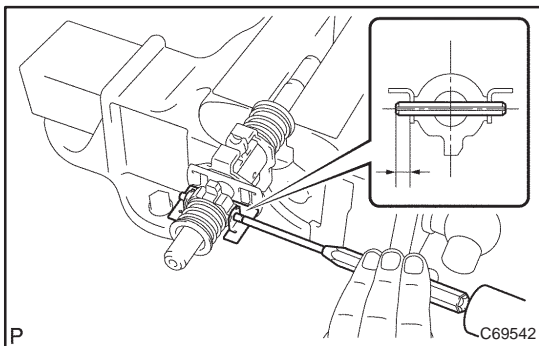

- (c) Install the transmission oil baffle. Using a pin punch(ϕ 5 mm) and a hammer, install the shift inner lever slotted pin to the shift & select lever shaft.

Clearance: 5.8 – 6.8mm (0.2303 – 0.2700 in.)

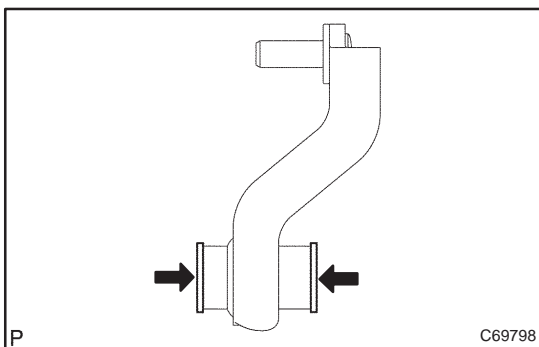

16. INSTALL SELECTING BELLCRANK NO.2 BUSH

- (a) Coat the 2 selecting bellcrank No.2 bushes with MP grease, install it to the selecting bellcrank No.2.

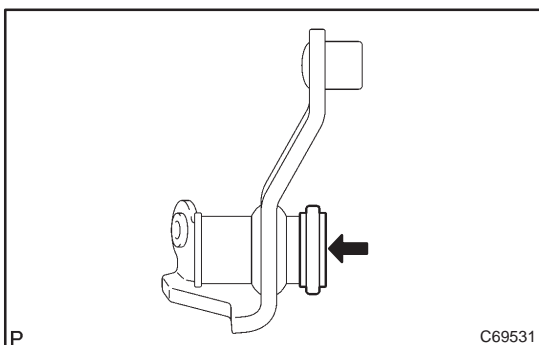

17. INSTALL SELECTING BELLCRANK DUST COVER NO.2

- (a) Coat the selecting bellcrank dust cover No.2 with MP grease, install it to the selecting bellcrank No.2.

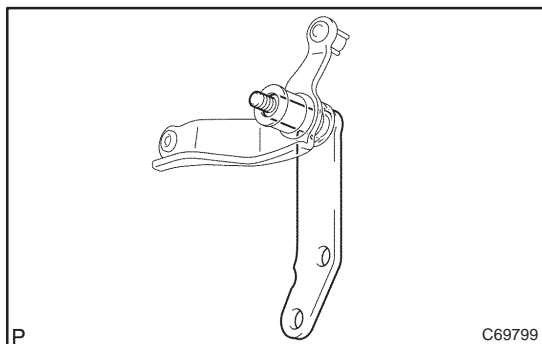

18. INSTALL SELECTING BELLCRANK SUPPORT SUB-ASSY

- (a) Install the selecting bellcrank support sub-assy to the selecting bellcrank No.2.

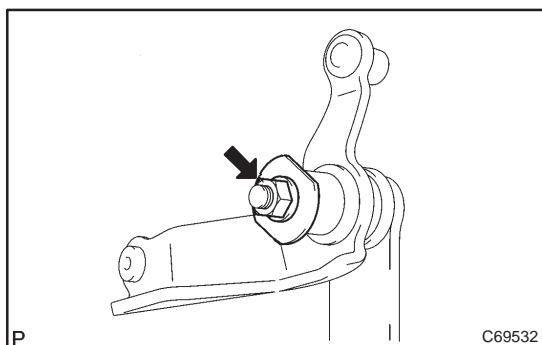

- (b) Install the selecting bellcrank No.2 plate washer, washer and nut.

Torque: 12N·m (120 kgf·cm, 9 ft·lbf)

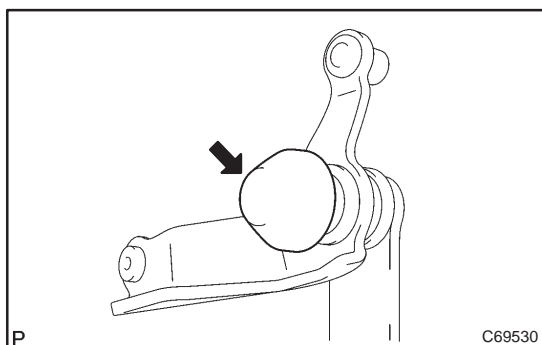

19. INSTALL SELECTING BELLCRANK DUST COVER NO.1

- (a) Install the selecting bellcrank dust cover No.1 to the selecting bellcrank No.2.

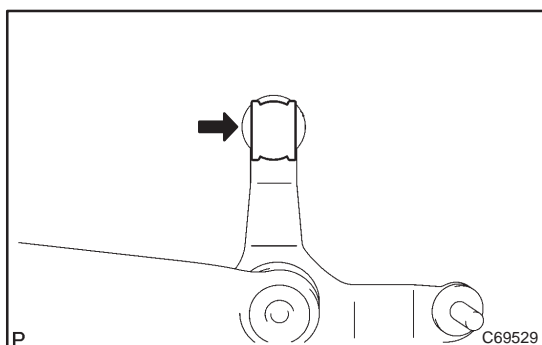

20. INSTALL CONTROL SHIFT LEVER BUSH

- (a) Install the control shift lever bush to the selecting bell crank No.2.